

# CARBONE BENCH

## TECHNICAL SHEET

## VISUALIZATION

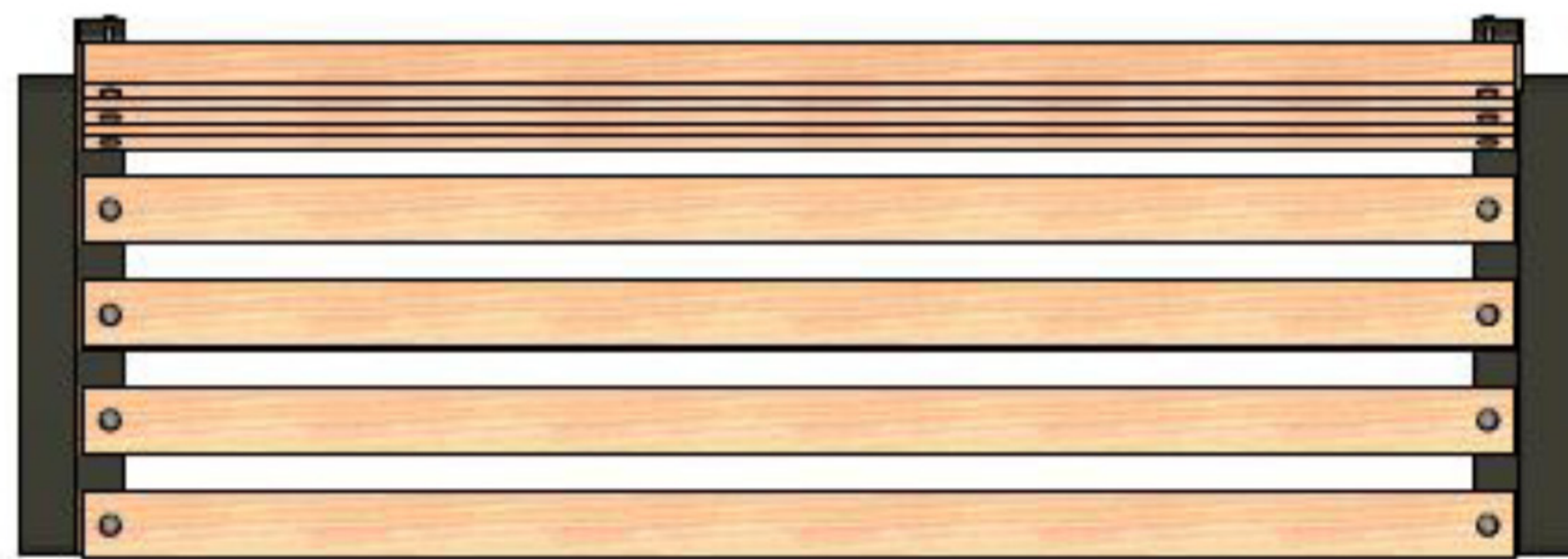
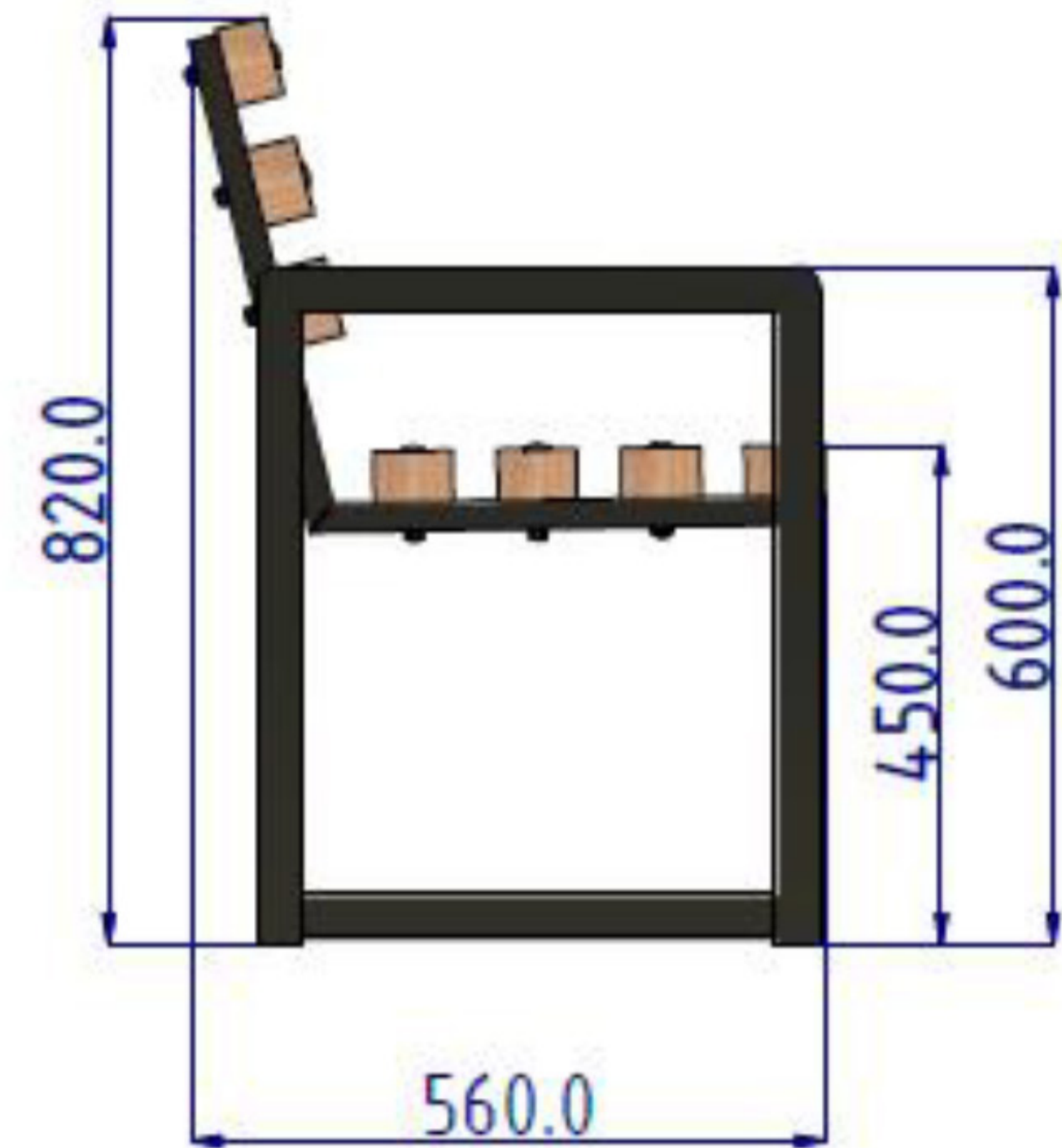
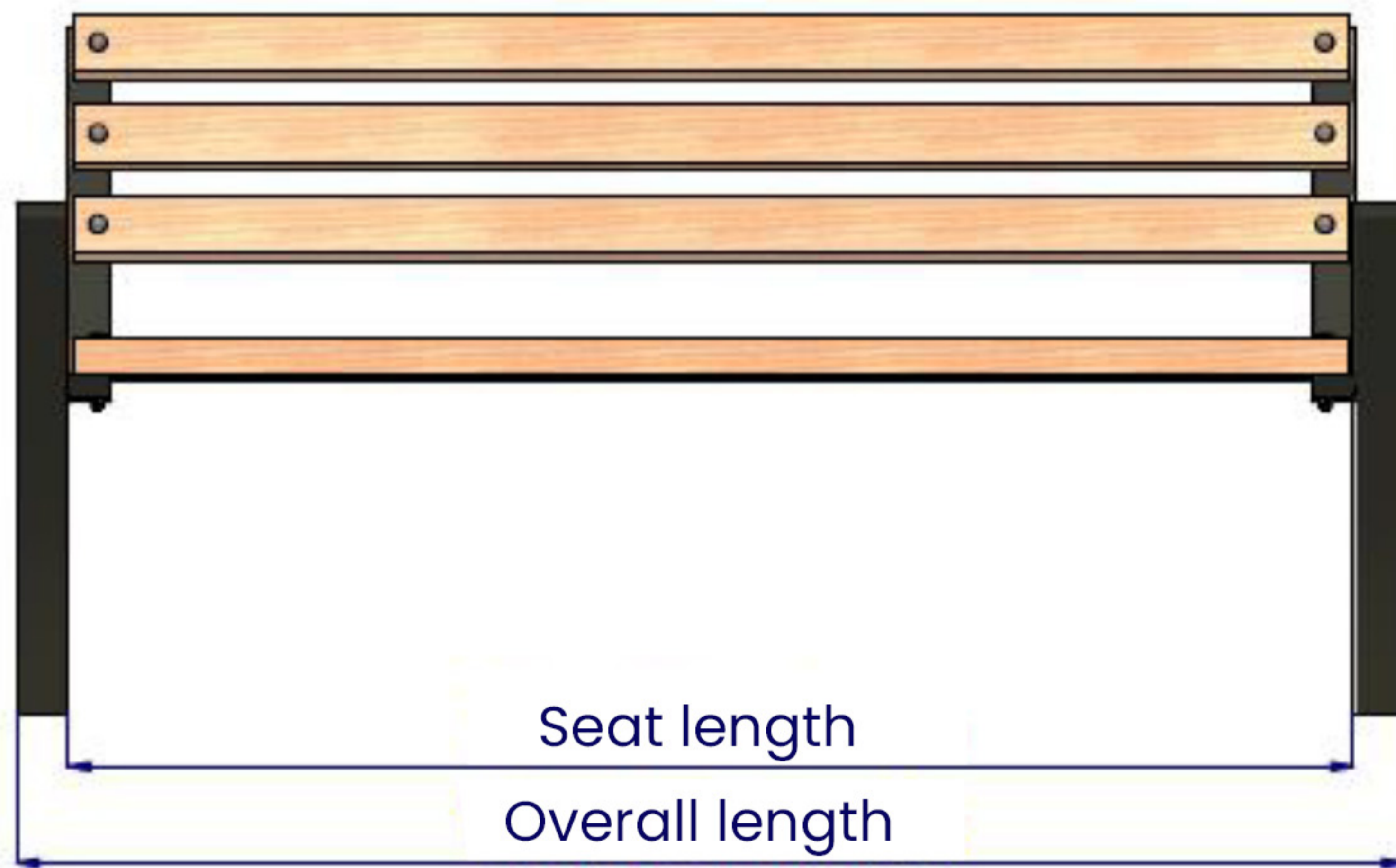

PRIMARIO  
GRANDE

## DIMENSIONS

Carbone bench	<b>100</b>	<b>125</b>	<b>150</b>	<b>175</b>	<b>200</b>	<b>220</b>
Overall length*	<b>1130,0</b>	<b>1380,0</b>	<b>1630,0</b>	<b>1880,0</b>	<b>2130,0</b>	<b>2340,0</b>
Seat length*	<b>1000,0</b>	<b>1250,0</b>	<b>1500,0</b>	<b>1750,0</b>	<b>2000,0</b>	<b>2200,0</b>
Weight*	<b>28,0</b>	<b>31,0</b>	<b>34,0</b>	<b>37,0</b>	<b>40,0</b>	<b>43,0</b>
Overall height*	<b>820,0</b>					
Overall width*	<b>560,0</b>					
Seat width*	<b>400,0</b>					
Seat height*	<b>450,0</b>					
Backrest height*	<b>290,0</b>					
Board dimensions*	<b>45,0 x 70,0</b>					

\*dimensions in mm, weight in kg

## TECHNICAL DATA

1. welded steel structure made of 60x40, 50x25 profiles using S235 grade steel.
2. Powder-coated frame.
3. boards dried, dip-painted.
4. possibility to assemble to the ground through holes fi 10 mm.